

ECLCP DC RSPC

EC Rcaflmjmw - The success of DG batteries comes from the internationally superior Gel technology. It is ideal for standby or frequent cyclic discharge applications under extreme environments

pmlr aac Amlcargml - Front access connection for fast, easy installation and maintenance with standard width for 19' and 23' ETSI racks.

-POH 4FSW DF- Especially designed for telecommunication use with 10+ years design life in float service. By combining the newly developed paste formula with up-to-date GEL structures, this range features 12 years design life.

lrcl lac cc ml n c - Proven VRLA technology guarantees safe operation without maintenance and 'non-restricted article' status for transportation.

Bcggelcb+Gl cg ggrw - Cutting-edge manufacturing and process control combined with meticulous quality assurance procedures guarantee consistent and dependable performance

GENERAL FEATURES

mm

Unit: mm

Length	410±1	Total Height	286±1
Width	110±1	Weight(kg)	33.0±1
Height	286±1		

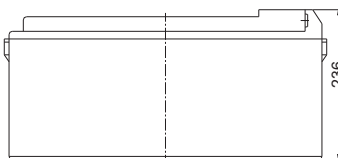

TERMINALS

mm

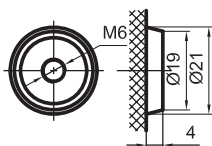

F8 Terminal

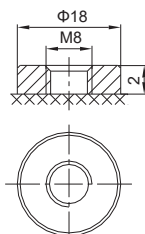

F14 Terminal

PERFORMANCE SPECIFICATIONS

Nominal Voltage	12V(6 cells)	
Design Floating Life @25°C	12 Years	
Nominal Capacity @25°C	20 hour rate	105.0Ah
	5.25A to 10.50V	
	10 hour rate	91.2Ah
	9.12A to 10.50V	
Internal Resistance	5 hour rate	79.5Ah
	15.9A to 10.50V	
	3 hour rate	71.7Ah
	23.9A to 9.60V	
Energy Density (20-hr. rate)	1 hour rate	58.7Ah
	58.7A to 9.60V	
Specific Energy (20-hr. rate)	Full Charged Battery@25°C	<7.5mΩ
Shelf Life (nominal capacity at 20°C)	1 Month	97%
	3 Months	91%
	6 Months	83%
Max Short-Duration Discharge Current	5 Sec	1050A
Standby Use Charge (Constant Voltage) @25°C	Initial Charging	
	Current Less than 21A Voltage 13.6 - 13.8V	
Cycle Use Charge (Constant Voltage) @25°C	Initial Charging	
	Current Less than 21A Voltage 14.4 - 14.9V	
Operating Temperature Range	Charge	-20°C to 50°C
	Discharge	-40°C to 60°C

