

### GENERAL FEATURES

- **Long Service Life** - Thick plate design and efficient gas recombination yield a service life expectancy of up to 10 years in standby mode.
- **Low Internal Resistance** - Superb high-rate discharge characteristics ensure reliable performance in UPS and Telecom applications.
- **Maintenance-Free, Non-Spillable** - Proven VRLA technology guarantees safe operation without maintenance and 'non-restricted article' status for transportation.
- **Low Self-Discharge** - Lead-calcium alloy grids and use of high purity lead account for superior shelf-life characteristics permitting storage for extended periods of time.
- **Designed-In Reliability** - Cutting-edge manufacturing and process control combined with meticulous quality assurance procedures guarantee consistent and dependable performance

### PERFORMANCE SPECIFICATIONS

<b>Nominal Voltage</b>	2V(single cell)	
<b>Design Floating Life @25°C</b>	12 Years	
<b>Nominal Capacity @25°C</b>	20 hour rate 10.60A to 1.8V	212.0Ah
	<b>10 hour rate 20.0A to 1.8V</b>	<b>200.0Ah</b>
	5 hour rate 35A to 1.7V	175.0Ah
	3 hour rate 56.2A to 1.65V	168.6Ah
<b>Internal Resistance</b>	1 hour rate 130.8A to 1.6V	130.8Ah
	Full Charged Battery@25°C	<0.8mΩ
<b>Energy Density (10-hr. rate)</b>	64.27W-h/l	
<b>Specific Energy (10-hr. rate)</b>	28.57W-h/kg	
<b>Shelf Life (nominal capacity at 20°C)</b>	1 Month	97%
	3 Months	91%
	6 Months	83%
<b>Standby Use Charge (Constant Voltage) @25°C</b>	Initial Charging Current Less than 30A Voltage 2.23 - 2.27V	
	Initial Charging Current Less than 30A Voltage 2.33-2.37V	
<b>Cycle Use Charge (Constant Voltage) @25°C</b>	Charge	-20°C to 50°C
	Discharge	-40°C to 60°C
<b>Operating Temperature Range</b>		

### GENERAL FEATURES

mm

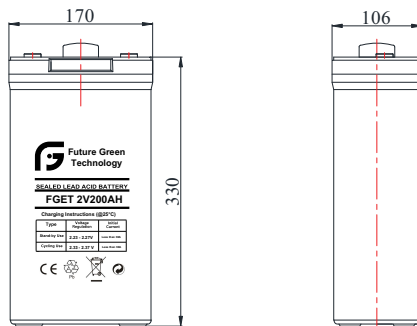

Unit: mm

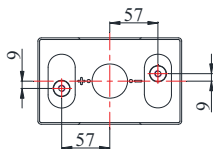

Length	170±1
Width	106±1
Height	330±1
Total Height	367±1
Weight(kg)	13.0±3%

### TERMINALS

mm

- T11 - THREADED INSERT - 8mm STUD

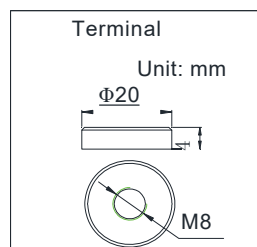

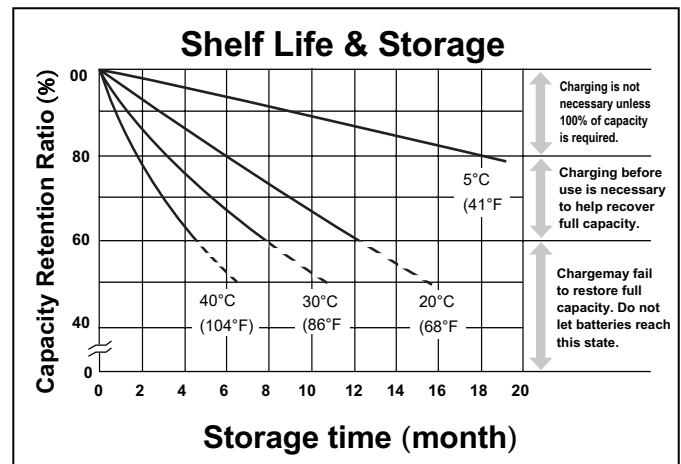
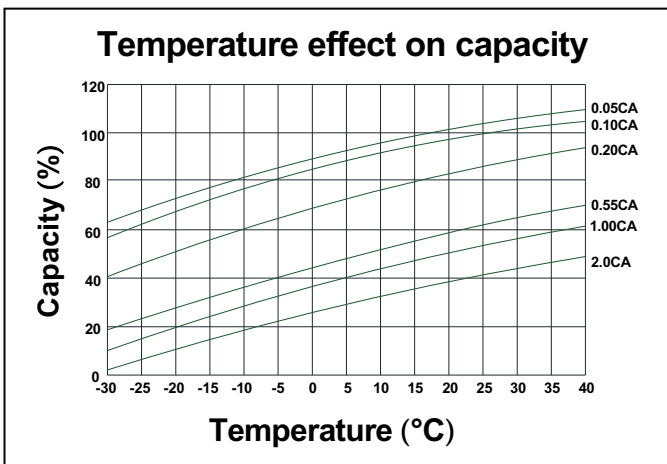
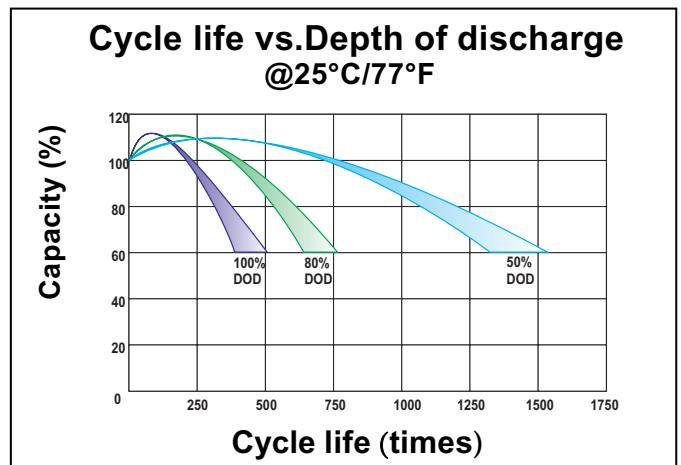
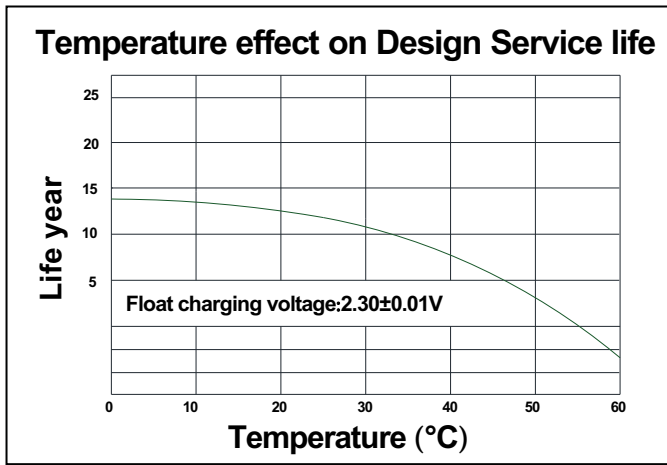
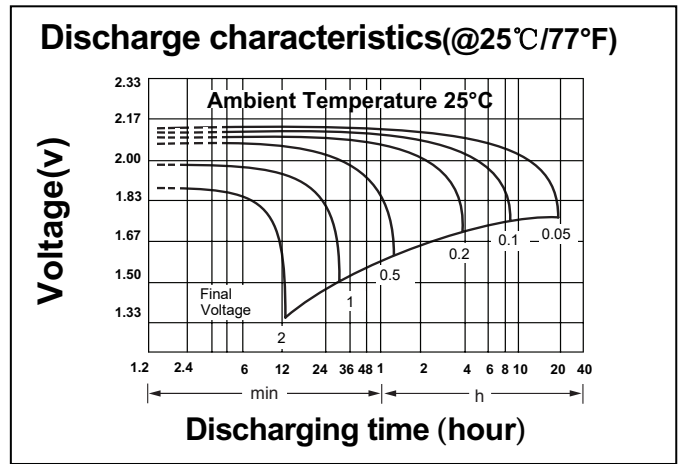
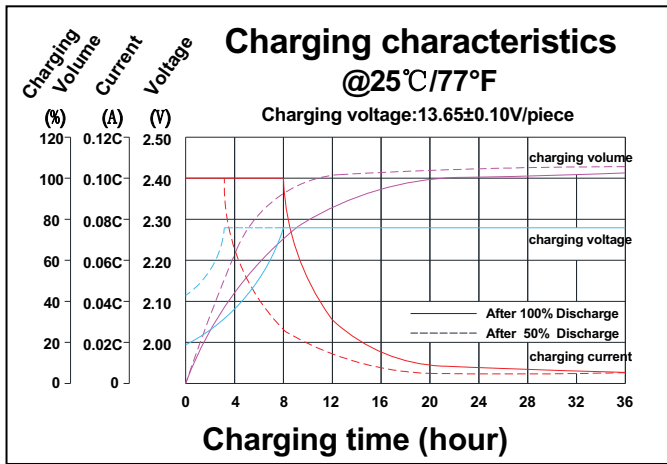

**CONSTANT CURRENT DISCHARGE RATINGS (Amperes at 25°C)**

F.V./Time	30min	45min	1h	2h	3h	4h	5h	6h	8h	10h	20h
1.60V	212.6	161.0	128.2	75.0	57.2	44.4	37.2	32.4	26.0	21.0	11.10
1.65V	201.4	154.8	124.0	72.6	55.4	43.4	36.6	31.8	25.8	20.6	11.00
1.70V	195.6	149.2	120.6	70.6	54.0	42.4	35.8	31.2	25.4	20.4	10.88
1.75V	187.0	142.6	116.2	68.8	52.8	41.4	35.2	30.6	25.2	20.2	10.78
1.80V	180.2	137.4	112.2	66.2	51.2	40.4	34.4	30.0	24.4	20.0	10.60