

### GENERAL FEATURES

- **Long Service Life** - Thick plate design and efficient gas recombination yield a service life expectancy of up to 10 years in standby mode.
- **Low Internal Resistance** - Superb high-rate discharge characteristics ensure reliable performance in UPS and Telecom applications.
- **Maintenance-Free, Non-Spillable** - Proven VRLA technology guarantees safe operation without maintenance and 'non-restricted article' status for transportation.
- **Low Self-Discharge** - Lead-calcium alloy grids and use of high purity lead account for superior shelf-life characteristics permitting storage for extended periods of time.
- **Designed-In Reliability** - Cutting-edge manufacturing and process control combined with meticulous quality assurance procedures guarantee consistent and dependable performance

### GENERAL FEATURES

mm

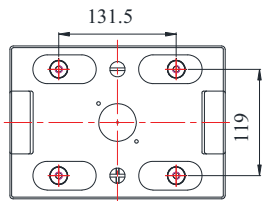

Unit: mm

Length	241±1
Width	171±1
Height	330±1
Total Height	367±1
Weight(kg)	31.0±3%

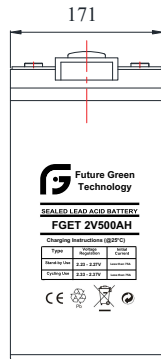
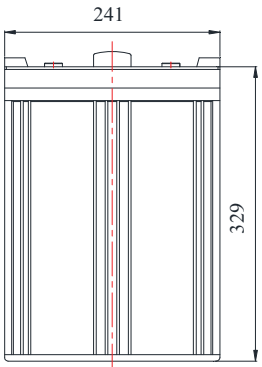

### TERMINALS

mm

- T11 - THREADED INSERT - 8mm STUD

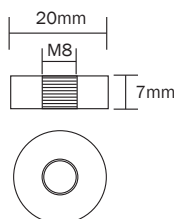

### PERFORMANCE SPECIFICATIONS

<b>Nominal Voltage</b>	2V(single cell)	
<b>Design Floating Life @25°C</b>	12 Years	
	20 hour rate	530.0Ah
	26.5A to 1.8V	
	<b>10 hour rate</b>	<b>500.0Ah</b>
	<b>50.0A to 1.8V</b>	
<b>Nominal Capacity @25°C</b>	5 hour rate	437.5Ah
	87.5A to 1.7V	
	3 hour rate	421.5Ah
	140.5A to 1.65V	
	1 hour rate	327.0Ah
	327.0A to 1.6V	
<b>Internal Resistance</b>	Full Charged Battery@25°C	<0.53mΩ
<b>Energy Density (10-hr. rate)</b>	66.48W-h/l	
<b>Specific Energy (10-hr. rate)</b>	33.34W-h/kg	
	1 Month	97%
<b>Shelf Life (nominal capacity at 20°C)</b>	3 Months	91%
	6 Months	83%
<b>Standby Use Charge (Constant Voltage) @25°C</b>	Initial Charging Current	Less than 75A
	Voltage	2.23 - 2.27V
<b>Cycle Use Charge (Constant Voltage) @25°C</b>	Initial Charging Current	Less than 75A
	Voltage	2.33-2.37V
	Charge	-20°C to 50°C
<b>Operating Temperature Range</b>	Discharge	-40°C to 60°C

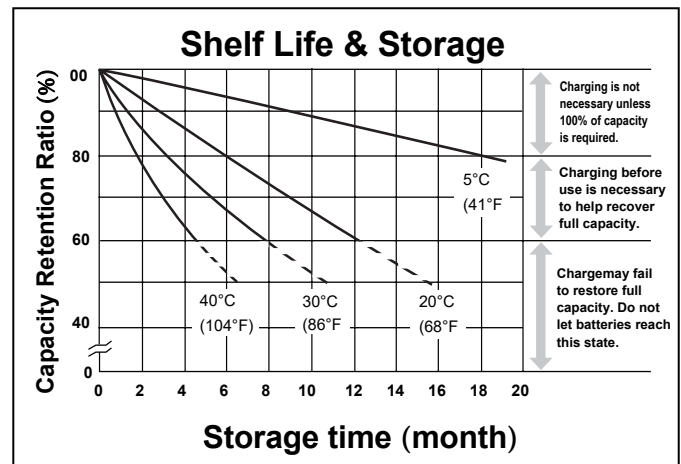
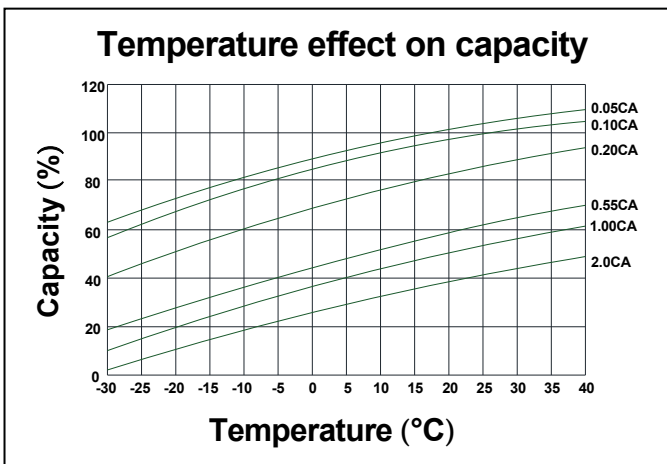
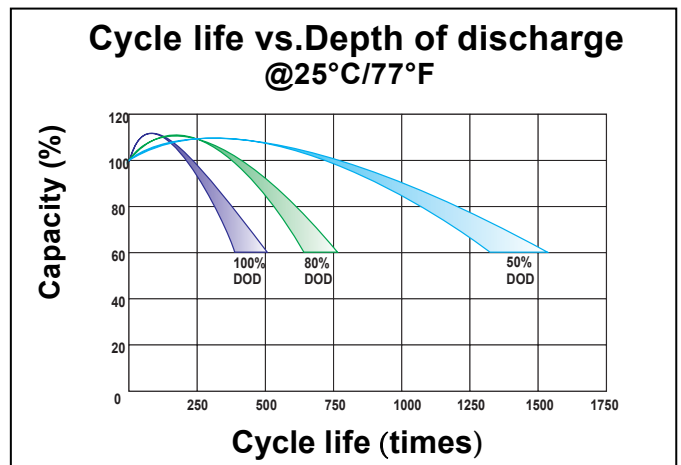
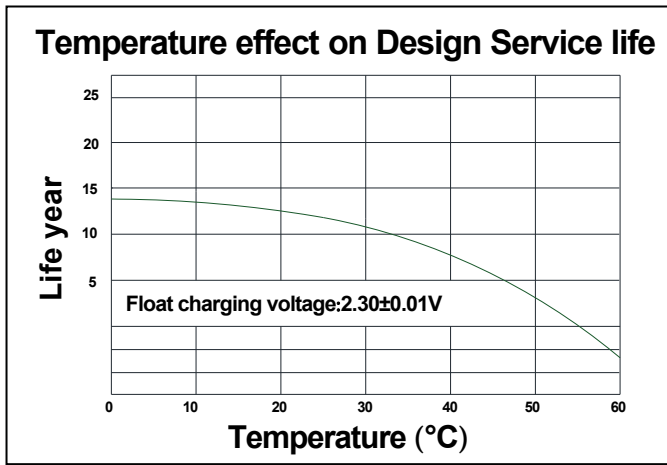
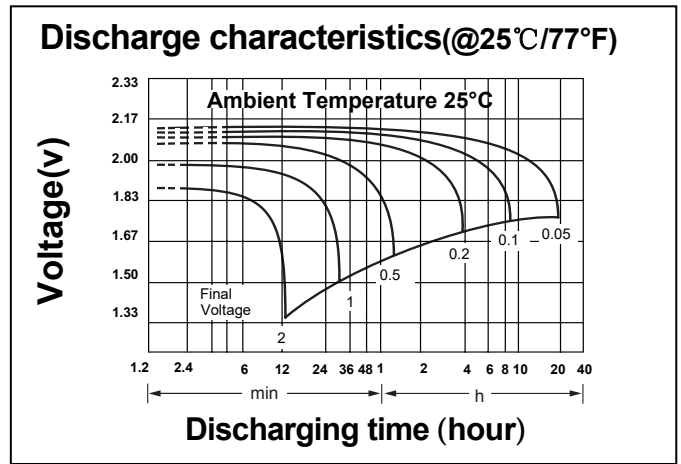
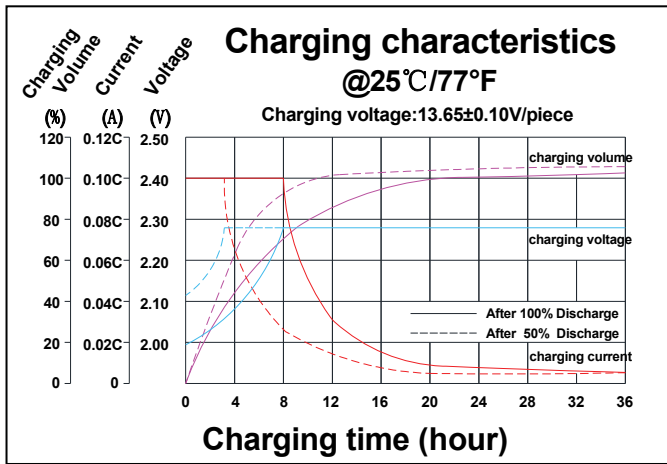

**CONSTANT CURRENT DISCHARGE RATINGS (Amperes at 25°C)**

F.V/Time	30min	45min	1h	2h	3h	4h	5h	6h	8h	10h	20h
1.60V	531.5	402.5	320.5	187.5	143.0	111.0	93.0	81.0	65.0	52.5	27.75
1.65V	503.5	387.0	310.0	181.5	138.5	108.5	91.5	79.5	64.5	51.5	27.50
1.70V	489.0	373.0	301.5	176.5	135.0	106.0	89.5	78.0	63.5	51.0	27.20
1.75V	467.5	356.5	290.5	172.0	132.0	103.5	88.0	76.5	63.0	50.5	26.95
1.80V	450.5	343.5	280.5	165.5	128.0	101.0	86.0	75.0	61.0	50.0	26.50