

### GENERAL FEATURES

- Electric Vehicle/Bike/Tricycle
- Electric Wheelchair
- Electric Scooter
- Electric play Car for children
- Garbage Truck
- Patrol Car

### GENERAL FEATURES

- High Corrosion Resistant Performance: Pb-Camulti-alloy grid
- High Energy Density and Power Density
- Excellent Charge Acceptance Ability
- Strong High and Low-Temperature Performance
- Optimized Capability of instant High-current Discharging
- Low self-discharge rate

### PERFORMANCE SPECIFICATIONS

Nominal Capacity (2hour rate)	<b>13.3Ah</b>	
Design Life @25°C	5 years	
Terminal	M5	
Approx. Weight	4.35kg (9.60lbs)	
Container Material	ABS	
Rated Capacity	10 hour rate (1.46A to 10.5V)	<b>14.6Ah</b>
	2 hour rate (6.65A to 10.5V)	<b>13.3Ah</b>
	1 hour rate (11.7A to 10.5V)	<b>11.7Ah</b>
Discharge Temperature	-20~50°C	
Charge Temperature	-20~40°C	
Storage Temperature	-20~50°C	
Float use Charge (Constant Voltage) @25°C	13.6~13.9V	
Cycle Use Charge (Constant Voltage) @25°C	14.7-14.9V	
Maximum charging current	2.66A	
Self discharge @25°C	3% of capacity declined per month	

### MEASUREMENT

Dimension: 151(L)×99(W)×98(H)×98.5(TH) Unit: mm

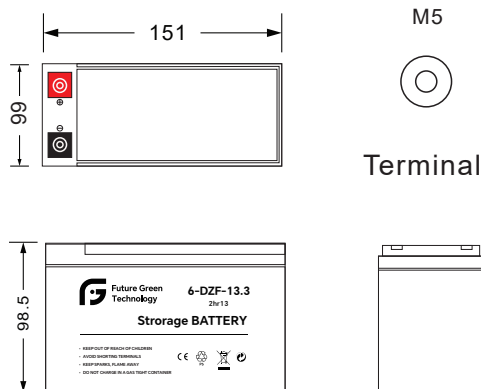

### Constant Current Discharge Characteristics Unit: A (25°C, 77°F)

F.V/Time	5Min	15Min	30Min	1h	2h	3h	5h	8h	10h	20h
1.60V	59.50	32.00	19.000	12.000	6.840	4.770	2.970	1.910	1.510	0.843
1.65V	57.70	31.00	18.700	12.000	6.810	4.720	2.940	1.890	1.490	0.838
1.70V	55.30	30.30	18.300	11.900	6.760	4.660	2.920	1.870	1.480	0.834
1.75V	51.00	29.30	18.200	11.700	6.650	4.600	2.880	1.850	1.460	0.830
1.80V	45.60	27.30	17.400	11.400	6.530	4.570	2.800	1.800	1.450	0.825
1.85V	40.70	24.400	15.900	10.600	6.200	4.310	2.670	1.710	1.410	0.812

**Constant Power Discharge Characteristics Unit: W/cell(25°C, 77°F)**

F.V/Time	5Min	15Min	30Min	1h	2h	3h	5h	8h	10h	20h
1.60V	100.00	56.30	34.400	22.800	12.900	9.080	5.640	3.700	2.900	1.660
1.65V	96.20	55.30	34.100	22.600	12.900	8.960	5.610	3.670	2.870	1.650
1.70V	95.20	54.70	34.100	22.400	12.900	8.910	5.560	3.660	2.840	1.650
1.75V	89.00	54.30	33.900	22.200	12.800	8.860	5.530	3.600	2.810	1.650
1.80V	81.70	51.30	33.100	22.100	12.700	8.820	5.470	3.500	2.780	1.640
1.85V	73.00	45.900	30.400	20.500	12.200	8.390	5.220	3.370	2.740	1.620

Disclaimer: Manufacturers have the right to self-modify the parameters of the product updates, please keep in touch with manufacturers to obtain the latest information.

**Discharge characteristic**

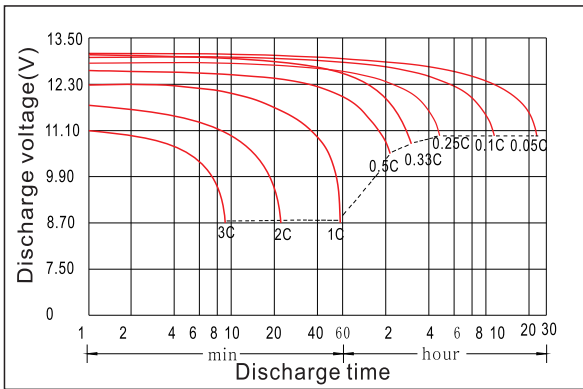

**Charging characteristic**

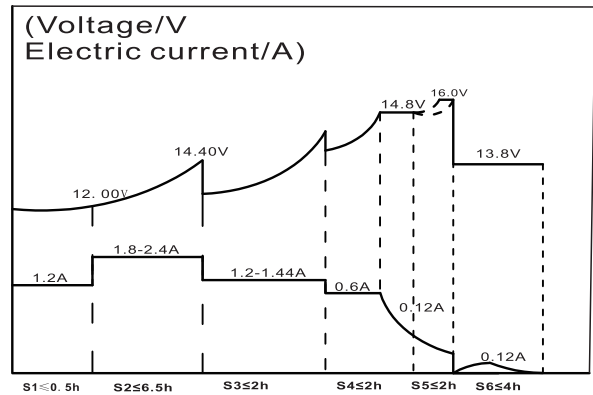

**The effect of temperature on capacity**

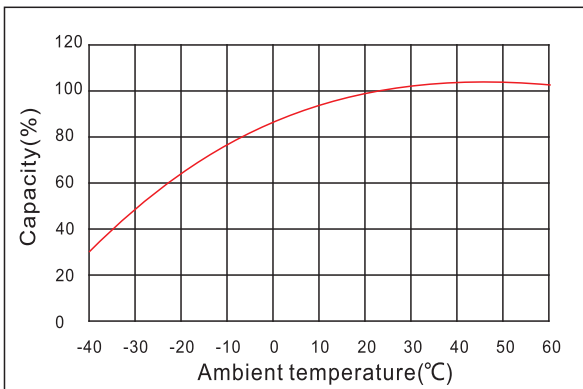

**The effect of discharge depth on cycle life**

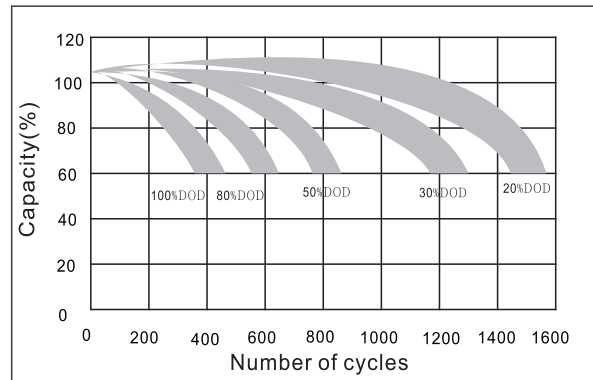

**Curves of self-discharge**

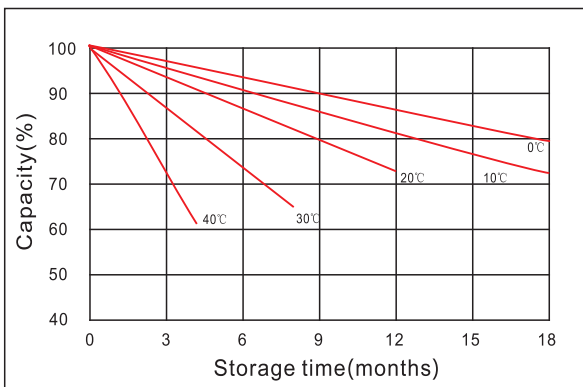

**Curves of open circuit voltage vs. capacity**

